

# JOY TO THE WORLD CHRISTMAS SHAKER CARD



## HERE'S WHAT YOU NEED

- Cardstock (I used red and white)
- Liquid Glue
- 1/4" Double Sided Foam Tape
- Confetti or Chunky Glitter
- Transparency Sheet
- Electronic cutter (cricut explore or maker, silhouette, or other cutter)
- Cut File – **Joy to the World Shaker Card BA2305** (available for free in my [resource library](#))

## HERE'S WHAT YOU DO

### STEP 1: DOWNLOAD THE FREE SVG FILE

The first thing you'll need to do is get the free SVG file you'll use for this project. I keep all the SVG files I use for the projects I make in my SVG Library. These SVG files work with Cricut and Silhouette machines, as well as many others. This library is open to everyone and is free! You can access the [library here](#). Look for the file called **Joy to the World Shaker Card BA2305**. It will be listed under the Craftmas 2023 Category-Day 5.

## STEP 2: CUT THE PIECES FOR THE PENGUIN

Open the design in your cutting software and resize the design. I resized my design to 16" wide. That will make the card about 4.5" x 5.75". It's also the biggest size you can make the envelope. If you're using Cricut Design Space, you'll need to ungroup the layers. Then click on the red envelope and perforation lines and attach them together. Do the same with the white card and perforation lines.

Once everything is sized correctly, cut out the pieces with your Cricut or Silhouette.

Once the cardstock is finished cutting, carefully remove it from the cutting mat. You'll want to slightly bend the cutting mat and carefully pull off the cardstock. If the pieces aren't coming off easily, you can use a spatula to help remove them.

The black rectangle in the design needs to be cut out of a transparency sheet (or something similar).



## STEP 3: ASSEMBLE THE ENVELOPE

Fold along all the perforation lines of the envelope.



Fold the side tabs back. Add glue to both of the tabs, stopping at about 1" from the top of the tab.

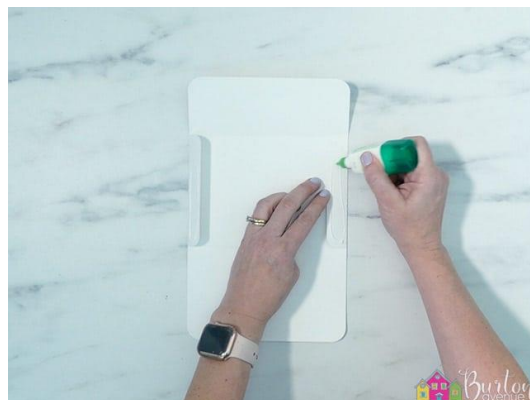

Fold up the bottom flap to form the envelope.

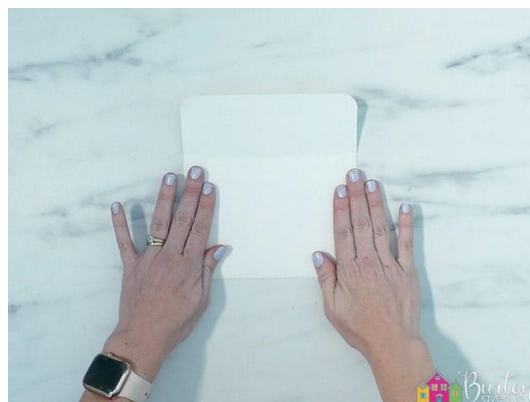

## STEP 4: ASSEMBLE THE CARD

Flip the red portion of the card over and add glue along the perimeter. You can also add glue to the letters. You'll want to do this sparingly so the glue doesn't seep out when the transparency sheet is applied.



Next, add double-sided foam tape to the perimeter of the card. Make sure all the corners touch so the confetti can't get out.



Add confetti or glitter to the card.

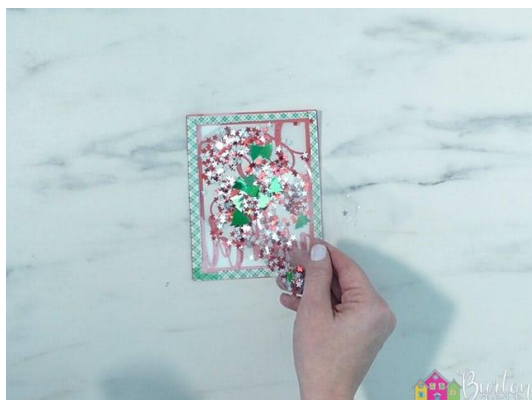

Pull the adhesive backing off the double-sided tape.



Fold the white card in half.



Match up the edges of the red and white pieces and press down. Make sure the fold of the white card is on the right side.



Turn the card over and shake up the confetti.



And now you have a super cute card and envelope for Christmas!

